

Electrodes

Metal Samples provides electrodes compatible with our various probes and instruments, as well as those of most other major manufacturers. Other electrodes not shown here are also available. Electrodes are made from a variety of materials (see Alloys list).



P/N EL400

Typically used for 2-electrode probes.

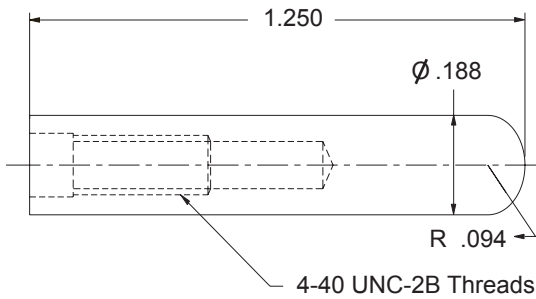

Surface Finish: Approx. 8 - 16 RMS Surface area: .736 in²

P/N EL405

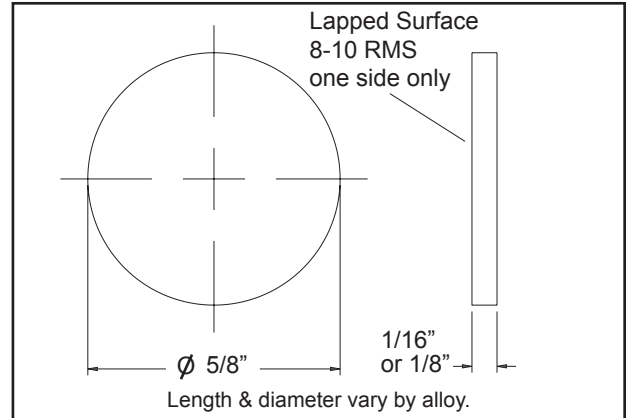

P/N EL410

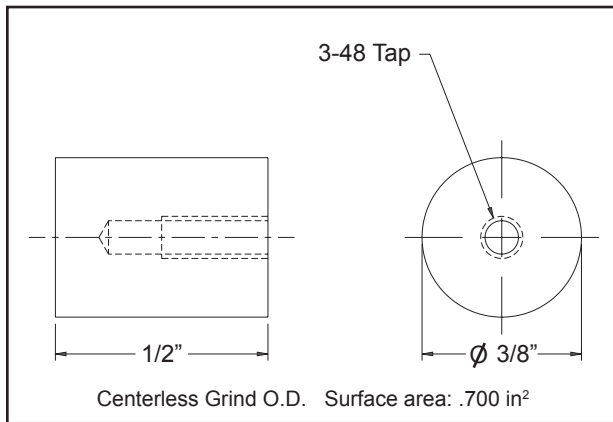

P/N EL412

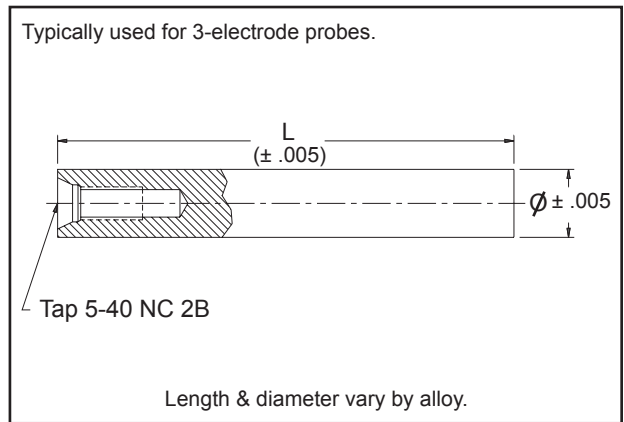

Gaskets Commonly used with Electro-Chemical Apparatus

P/N MI2616

Teflon® gasket for use with EG&G
 \varnothing 5/8" disc holder

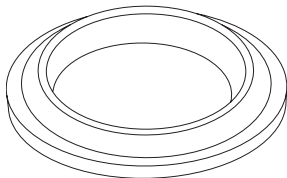

P/N MI2604

Teflon® compression spacer for electro-chemical electrode mounting (per ASTM G5)

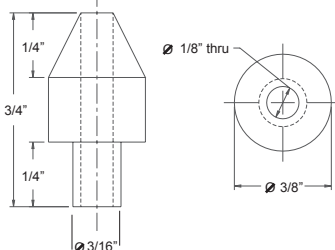

P/N MI2605

Teflon® compression gasket for electro-chemical electrode mounting (per ASTM G5)

