

MH™ Access Fitting Bodies

Non-Tee Types

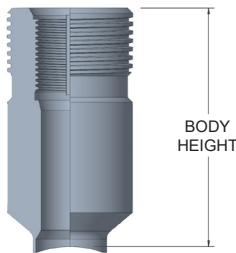

Model MH1000
Flareweld

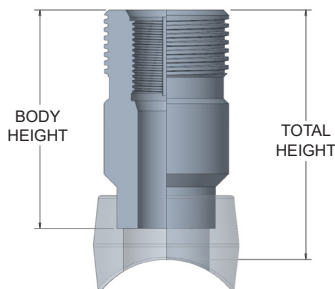

Model MH3000
Socket Weld

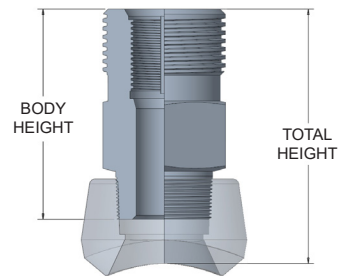

Model MH4000
NPT

Model	Body Height (in)	Weight (lbs)	Total Height (in)
MH1000 Flareweld	5.50	7	5.50
MH3000 Socket Weld	5.25	6	6.50*
MH4000 NPT	5.14	6	6.50**

* Overall height of access fitting when attached to a class 6000# Sockolet®¹

** Overall height of access fitting when attached to a class 6000# Threadolet®¹

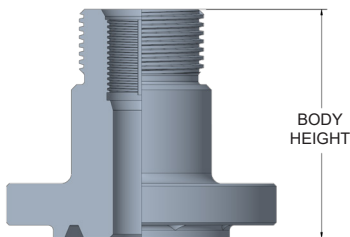

Model MH5000
ANSI Flange RJ

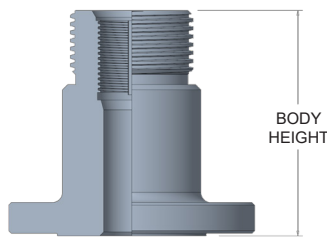

Model MH6000
ANSI Flange RF

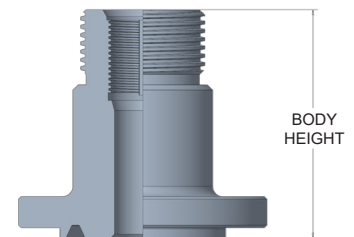

Model MH7000
API Flange

2" ANSI Flange Rating	Height (in)	Weight (lbs)
150#	5.50	11
300#	5.50	13
4/600#	5.50	14
9/1500#	5.50	27
2500#	6.50	42

2-1/16" API Flange Rating	Height (in)	Weight (lbs)
2000#	5.50	14
3/5000#	5.50	27
10000#	6.50	42

Temperature Rating: -20° F (-28.9° C) to +350° F (176.6° C)
Pressure Rating: 6000 PSI or as Flange Rating

¹ Sockolet® and Threadolet® are registered trademarks of Bonney Forge Corporation.

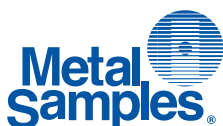

Metal Samples Company

A Division of Alabama Specialty Products, Inc.

152 Metal Samples Rd., Munford, AL 36268 Phone: (256) 358-4202 Fax: (256) 358-4515

E-mail: msc@alspi.com Internet: www.metalsamples.com

Tee Types

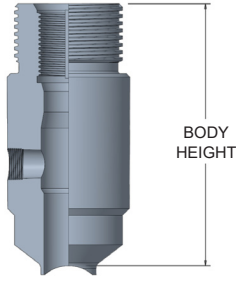

Model MH1100
Flareweld

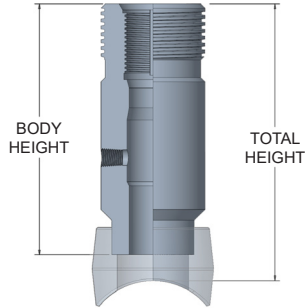

Model MH3100
Socket Weld

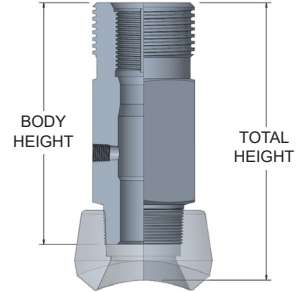

Model MH4100
NPT

Model	1/4" T			1/2" T			3/4" T			1" T		
	Body Height (in)	Weight (lbs)	Total Height (in)	Body Height (in)	Weight (lbs)	Total Height (in)	Body Height (in)	Weight (lbs)	Total Height (in)	Body Height (in)	Weight (lbs)	Total Height (in)
MH1100	7.50	11	7.50	7.50	11	7.50	7.50	11	7.50	7.50	11	7.50
MH3100	7.25	10	8.50*	7.25	10	8.50*	7.25	10	8.50*	7.25	10	8.50*
MH4100	7.14	10	8.50**	7.14	10	8.50**	7.14	10	8.50**	7.14	10	8.50**

* Overall height of access fitting when attached to a class 6000# Sockolet® 1

** Overall height of access fitting when attached to a class 6000# Threadolet® 1

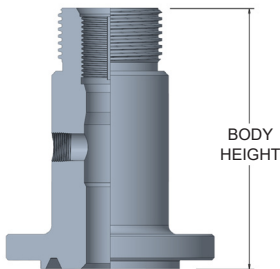

Model MH5100
ANSI Flange RJ

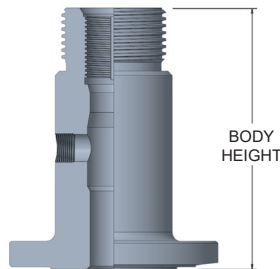

Model MH6100
ANSI Flange RF

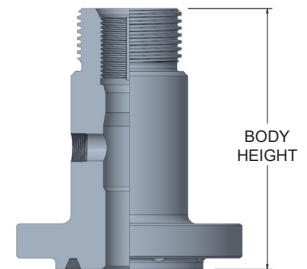

Model MH7100
API Flange

Model	2" Flange Size	1/4" T		1/2" T		3/4" T		1" T	
		Height (in)	Weight (lbs)	Height (in)	Weight (lbs)	Height (in)	Weight (lbs)	Height (in)	Weight (lbs)
MH5100 ANSI Flange RJ	150#	7.50	15	7.50	15	7.50	15	7.50	15
	300#	7.50	17	7.50	17	7.50	17	7.50	17
	4/600#	7.50	18	7.50	18	7.50	18	7.50	18
	9/1500#	7.50	31	7.50	31	7.50	31	7.50	31
	2500#	8.50	46	8.50	46	8.50	46	8.50	46
MH6100 ANSI Flange RF	150#	7.50	15	7.50	15	7.50	15	7.50	15
	300#	7.50	17	7.50	17	7.50	17	7.50	17
	4/600#	7.50	18	7.50	18	7.50	18	7.50	18
	9/1500#	7.50	31	7.50	31	7.50	31	7.50	31
	2500#	8.50	46	8.50	46	8.50	46	8.50	46
MH7100 API Flange	2000#	7.50	18	7.50	18	7.50	18	7.50	18
	3/5000#	7.50	31	7.50	31	7.50	31	7.50	31
	10000#	8.50	46	8.50	46	8.50	46	8.50	46

Temperature Rating: -20° F (-28.9° C) to +350° F (176.6° C)

Pressure Rating: 6000 PSI or as Flange Rating